

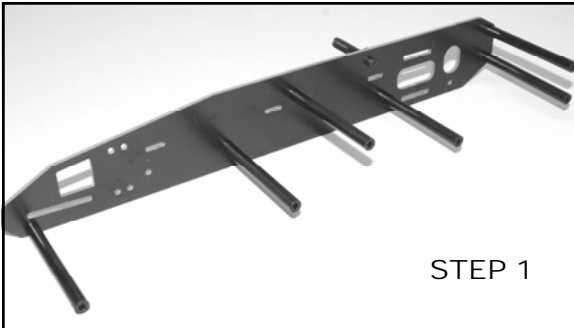

2010 R/C LEGENDS COUPE KIT LESS ELECTRICS
2011 R/C LEGENDS SEDAN KIT LESS ELECTRICS

THANKS FOR BUYING OUR LEGENDS CAR KIT. THE ASSEMBLY WILL NOT BE DIFFICULT IF YOU READ THE TEXT, LOOK AT THE PICTURES , AND THE EXPLODED VIEW DRAWING. YOU WILL NEED A SMALL PAIR OF PLIERS, A 1/4" SOCKET OR WRENCH, AND A 7/16 SOCKET FOR THE BODY POSTS AND DIFF. HEX WRENCHES TO FIT THE SOCKET HEAD SCREWS ARE PROVIDED.

THIS KIT REQUIRES A MOTOR , 4 CELL BATTERY PACK, 2 CHANNEL RADIO WITH 1 SERVO AND SPEEDCONTROL (ESC), PLUS A SERVO SAVER TO FIT THE BRAND OF SERVO YOU ARE USING. WE RECOMMEND THE TRINITY SS2226 SPEC MOTOR AND 2270 4-CELL BATTERY FOR LEGENDS RACING. YOU WILL ALSO NEED PAINT FOR THE LEXAN BODY.



STEP 1

STEP 1 OPEN BAG L1. INSTALL 6 CHASSIS SPACERS AND 1 SHORT BODY POST TO EITHER CHASSIS SIDE WITH 3/8 CAP SCREWS. HOLD THE SPACERS WITH PLIERS AND TIGHTEN THE SCREWS.

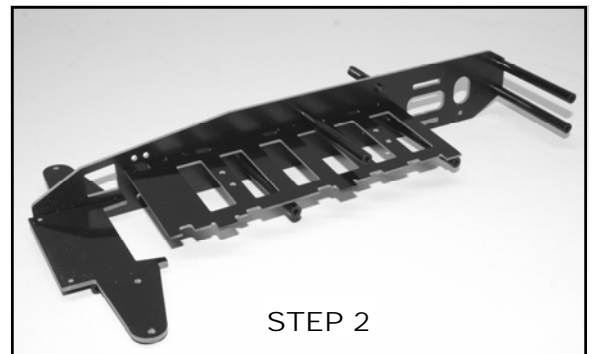

STEP 2

STEP 2 INSERT THE 5244 FRONT AXLE PLATE AND 5242 BATTERY TRAY INTO THE CHASSIS PLATE. FILE OR SAND THE TABS IF THEY FIT TOO TIGHTLY.

STEP 2 INSERT

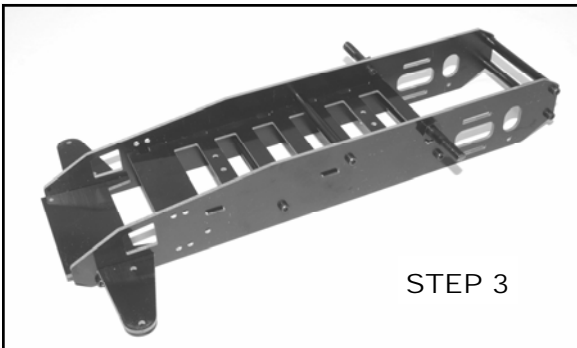

STEP 3

STEP 3 ATTACH THE OTHER SHORT BODY POST TO THE OTHER CHASSIS SIDE THEN SLIDE IT ONTO THE FRONT AXLE PLATE AND BATTERY TRAY. ATTACH WITH 3/8 CAP SCREWS. SET THE CHASSIS DOWN ON YOUR TABLE TO SEE IF IT SITS FLAT . IF NOT, HOLD BY BOTH ENDS AND TWIST AND RECHECK.

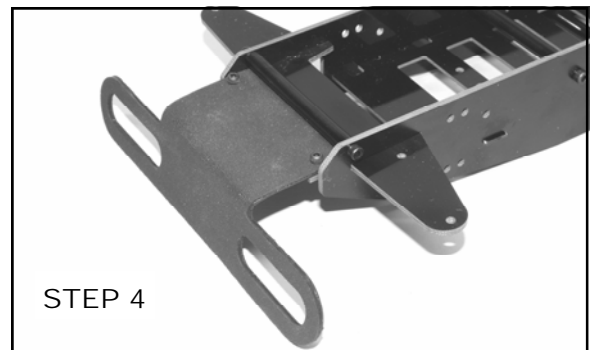

STEP 4

STEP 4 TURN THE CHASSIS OVER AND ATTACH THE BUMPER TO THE BOTTOM OF THE FRONT AXLE PLATE WITH TWO 1/4" SCREWS FROM THE BUMPER BAG.

STEP 4 TURN THE

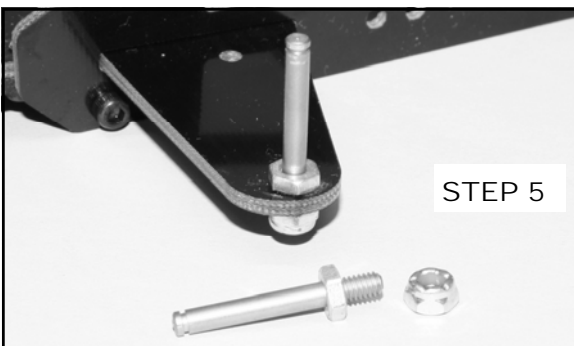

STEP 5

STEP 5 THREAD A JAM NUT (THIN ONE) ON EACH KINGPIN,INSERT THE KINGPIN THRU THE FRONT AXLE PLATE AND RETAIN WITH A LOCKNUT.

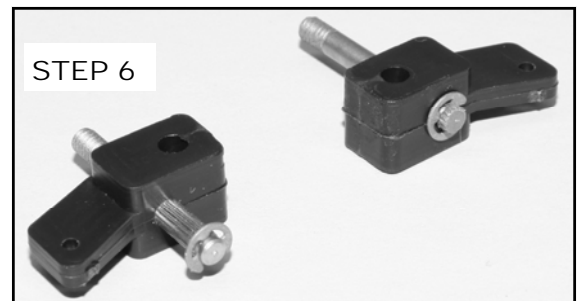

STEP 6

STEP 6 INSTALL A STUB AXLE IN EACH STEERING BLOCK , ADD AN E-CLIP AND PRESS IT IN AS SHOWN.

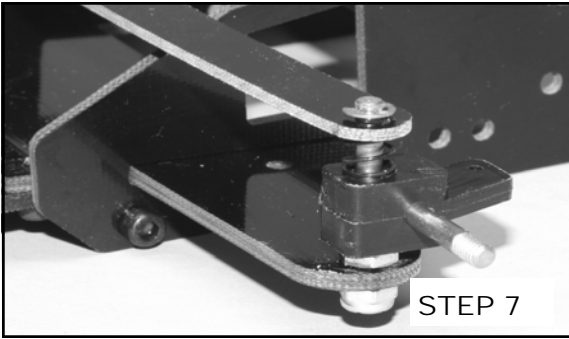

STEP 7 LUBE EACH KINGPIN WITH A SMALL AMOUNT OF GREASE OR SILICONE LUBE. SLIDE A STEERING BLOCK ON EACH ONE, ADD A SPRING, THEN THE KINGPIN BRACE, AND RETAIN WITH AN E-CLIP ON EACH ONE.

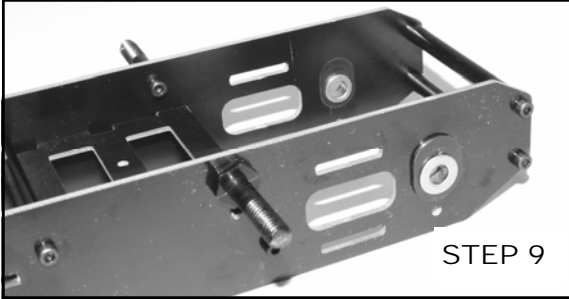

STEP 8 INSTALL A 2" BODY POST ON EACH SIDE OF THE FRONT AXLE PLATE WITH 3/8 CAP SCREWS.

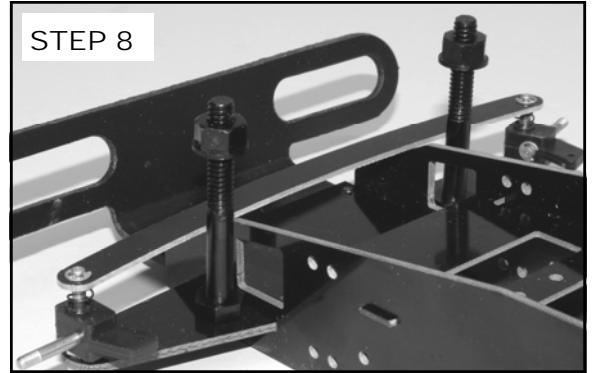

STEP 9 OPEN BAG L2. INSTALL A PLASTIC ADAPTOR IN EACH CHASSIS SIDE . MAKE SURE THEY ARE TURNED THE SAME WAY. PRESS A LARGE BUSHING INTO EACH ONE.

STEP 10 SNAP A 1/8 DIFF BALL INTO EVERY OTHER HOLE IN THE OUTER ROW OF THE AXLE GEAR. LUBE THEM WITH A SMALL AMOUNT OF SILICONE OR GREASE. SLIDE THE 1/16 WIDE AXLE SPACER ON THE LONG END OF THE AXLE , THEN SLIDE THE AXLE THRU THE BUSHINGS. ADD A 1/4" WIDE AXLE SPACER AND THE SETSCREW HUB. INSTALL TWO SETSCREWS IN THE HUB .LEAVE A SMALL AMOUNT OF SIDE PLAY IN THE AXLE AND TIGHTEN EACH SETSCREW A LITTLE AT A TIME TO KEEP FROM WARPING THE HUB. ASSEMBLE THE DIFF AS FOLLOWS: 1ST DRIVE RING, GEAR, 2ND DRIVE RING, ALUMINUM DIFF ADAPTOR, DIFF HUB, THIN STEEL WASHER, BALL THRUST BEARING, THICK STEEL WASHER, CONE WASHER, AND DIFF NUT. MAKE SURE THE DRIVE RINGS ARE IN PLACE. HOLD BOTH HUBS AND USE YOUR THUMB TO TURN THE GEAR. IT SHOULD BE FAIRLY HARD TO SLIP. YOU CAN ADJUST THE DIFF WHEN YOU BEGIN TO RUN YOUR CAR. PUT A DROP OF LIGHT OIL ON EACH AXLE BUSHING.

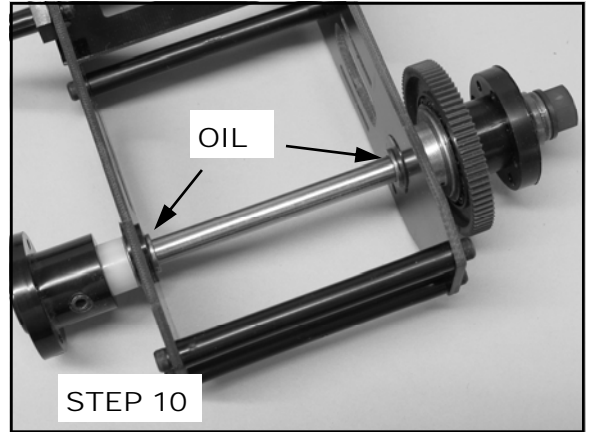

STEP 11 OPEN BAG 3. INSTALL THE PINION GEAR ON YOUR MOTOR WITH THE INCLUDED SETSCREW AND WRENCH. INSTALL THE MOTOR IN THE CHASSIS WITH TWO M3 SCREWS AND WASHERS. MAKE SURE YOUR PINION LINES UP WITH THE AXLE GEAR. ADJUST THE MOTOR BACK UNTIL THERE IS A SMALL AMOUNT OF PLAY BETWEEN THE GEARS AND TIGHTEN THE SCREWS. TURN THE AXLE A COUPLE OF TIMES AND RE-CHECK THE MESH.

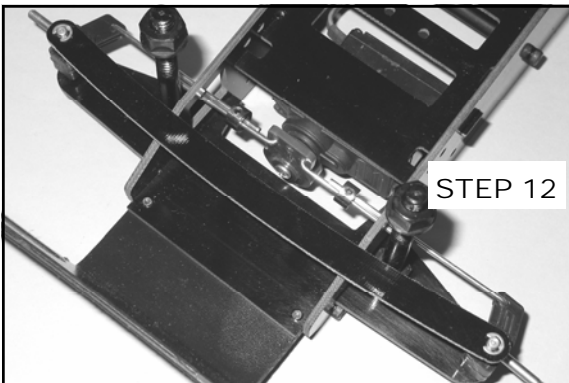
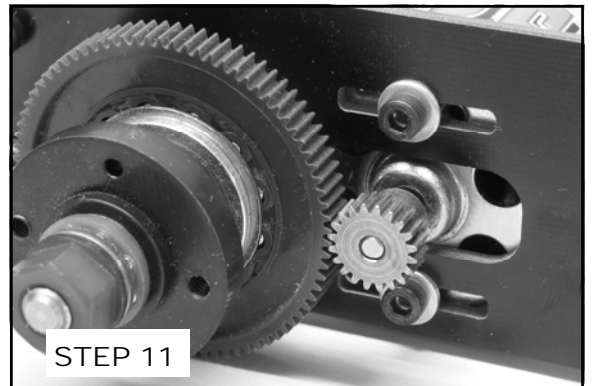

STEP 12 INSTALL YOUR STEERING SERVO IN PLACE UNDER THE BATTERY TRAY WITH SERVO TAPE. TRY TO GET THE OUTPUT NEAR THE CENTER. INSTALL THE SHORT LINKS IN THE SERVO SAVER AND THE LONG ONES IN THE STEERING BLOCKS. SLIDE THE COLLARS WITH SETSCREWS OVER THE LINKS, ALIGN YOUR STEERING BLOCKS SO THAT THE AXLES ARE STRAIGHT, AND TIGHTEN THE SETSCREWS. YOU CAN ALSO INSTALL A TIE STRAP AROUND THE SERVO AND BATTERY TRAY TO HELP HOLD IT IN PLACE.

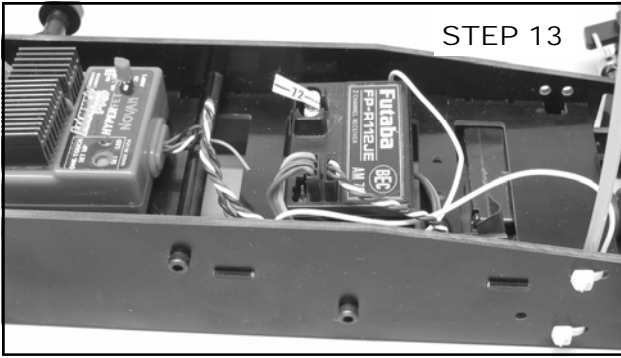

STEP 13 INSTALL YOUR ESC AND RECEIVER ON TOP OF THE BATTERY TRAY WITH SERVO TAPE. MAKE SURE YOU LEAVE ROOM JUST BEHIND THE UPPER CHASSIS SPACER FOR A TIE STRAP TO HOLD THE BATTERY PACK UNDER THE TRAY. RUN YOUR ANTENNA WIRE THROUGH THE ANTENNA TUBE AND USE TWO SMALL TIE STRAPS TO ATTACH THE ANTENNA TUBE TO EITHER SIDE OF THE CHASSIS. PLUG IN YOUR RADIO WIRES AND BUNDLE THE EXTRA WIRE ON TOP OF THE TRAY. WIRE YOUR ESC TO THE MOTOR ACCORDING TO THE MANUFACTURER'S INSTRUCTIONS.

STEP 14 TURN YOUR CHASSIS OVER AND INSTALL YOUR BATTERY PACK WITH A LARGE TIE STRAP. INSTALL YOUR RADIO SWITCH UNDER THE TRAY OR ON EITHER SIDE PLATE SO YOU CAN TURN THE CAR ON AND OFF WITHOUT REMOVING THE BODY. CHARGE YOUR BATTERY, TURN ON YOUR RADIO AND ADJUST IT ACCORDING TO THE MANUFACTURER'S INSTRUCTIONS. MAKE SURE THE STEERING AND THROTTLE WORK CORRECTLY. YOU SHOULD ALWAYS UNPLUG YOUR BATTERY PACK WHEN YOU ARE THROUGH RUNNING YOUR LEGENDS CAR.

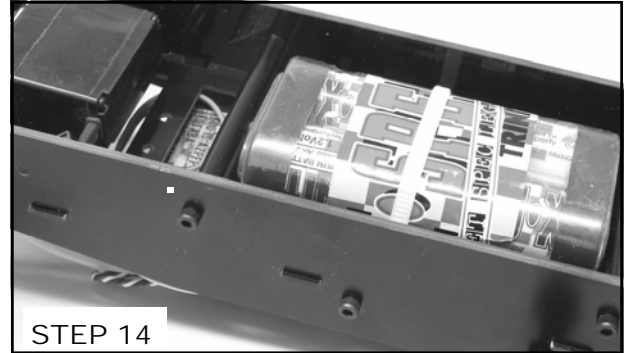

STEP 15 INSTALL BUSHINGS FROM BAG L3 IN EACH SIDE OF EACH FRONT WHEEL. LUBE THE AXLES WITH LIGHT OIL, INSTALL THE TIRES AND RETAIN WITH LOCKNUTS FROM BAG L1. INSTALL THE REAR TIRES WITH TWO 3/8 CAP SCREWS EACH FROM BAG L2.

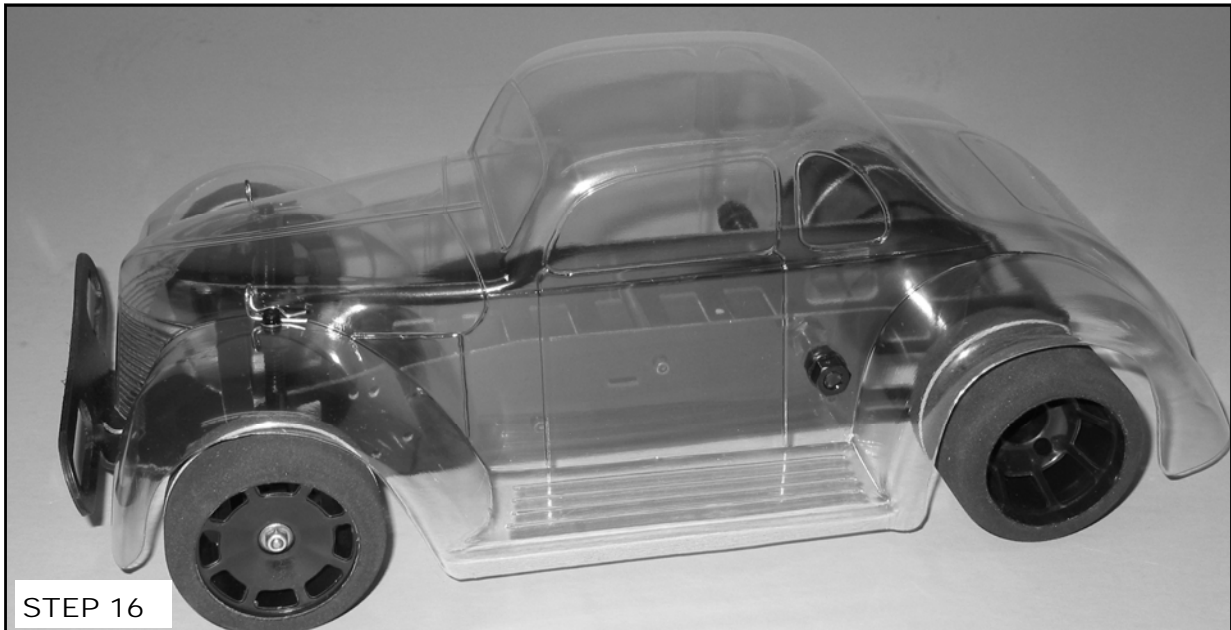

STEP 16 PAINT YOUR LEGENDS BODY AS DESIRED .THERE ARE PAINTS MADE FOR LEXAN AVAILABLE AT YOUR LOCAL HOBBY SHOP. SOME COMMERCIAL SPRAY PAINTS MADE FOR PLASTIC WILL STICK IF YOU SCUFF THE INSIDE SURFACE WITH SCOTCHBRITE PADS. WE PROVIDE WINDOW MASKS, THE REST IS UP TO YOU. AFTER PAINTING, TRIM THE BODY BY SCORING IT ON THE TRIM LINES WITH A SHARP HOBBY KNIFE AND BENDING IT AWAY FROM THE CUT UNTIL IT SNAPS. DRILL THE PRE-MARKED MOUNT HOLES, THEN PEEL THE PROTECTIVE FILM FROM THE OUTSIDE OF THE BODY BEFORE INSTALLING ANY DECALS. TEST YOUR STEERING TO MAKE SURE THAT YOUR FRONT TIRES DO NOT RUB THE BODY. RE-TRIM IF NECESSARY.

THE NEXT THING YOU NEED TO DO IS TO GO OUT AND HAVE FUN RACING YOUR R/C LEGENDS CAR!

FOR MORE INFO: www.rjspeed.com

KEEP THE FUN IN RACING WITH R/C LEGENDS!!