

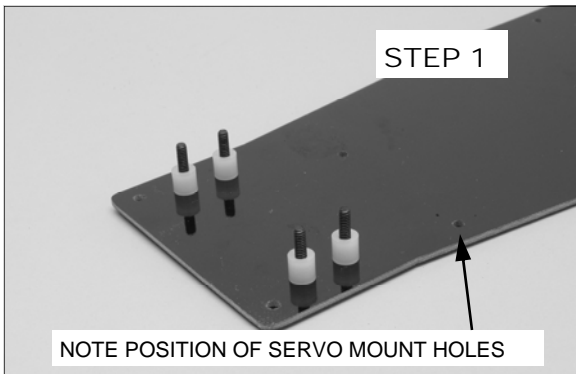

RJS2001 PRO STOCK KIT LESS ELECTRICS

THANKS FOR BUYING RJ SPEED'S PRO STOCK DRAG KIT. IT IS MADE FOR STRAIGHT LINE DRAG RACING AND CAN BE BROKEN IF RUN INTO SOLID OBJECTS REPEATEDLY AT HIGH SPEED. IT REQUIRES A MOTOR, BATTERY PACK, AND A TWO CHANNEL RADIO CONTROL UNIT WITH TWO SERVOS OR ONE SERVO AND AN ESC. A STANDARD SIZE OR MINI SERVO IS GOOD FOR THE STEERING, AND A MINI SERVO IS BEST TO MOUNT IN THE SWITCH PLATE IF YOU ARE GOING TO USE A MICRO SWITCH INSTEAD OF AN ESC. YOU WILL NEED A SMALL PAIR OF PLIERS, AND A 1/4" WRENCH OR NUTDRIVER. HEX WRENCHES TO FIT THE SOCKET HEAD SCREWS ARE INCLUDED IN THE KIT . YOU WILL ALSO NEED PAINT FOR THE LEXAN BODY AND WING.



STEP 1 REMOVE THE CHASSIS FROM BAG 1. OPEN BAG 2.INSERT FOUR 5/8 LONG SCREWS IN THE FOUR HOLES NEAR THE FRONT OF THE CHASSIS AND ADD A 1/4" SPACER ON EACH ONE.

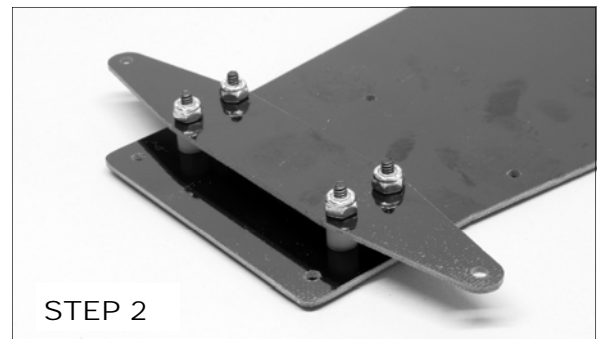

STEP 2 INSTALL THE FRONT AXLE PLATE ON THE SCREWS AND RETAIN WITH FOUR LOCKNUTS.

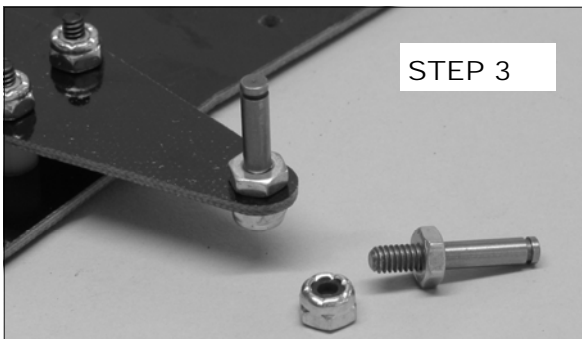

STEP 3 OPEN THE KINGPIN BAG (INSIDE BAG 2) INSTALL A THIN NUT ON EACH KINGPIN, INSERT IT INTO THE END OF THE FRONT AXLE PLATE, ADD A LOCKNUT AND TIGHTEN, REPEAT FOR THE OTHER SIDE.

STEP 4 PUT A DROP OF LIGHT OIL OR SILICONE LUBE ON EACH KINGPIN AND INSTALL A STEERING BLOCK ON EACH ONE WITH THE ANGLED PORTION POINTING IN. RETAIN EACH ONE WITH AN E-CLIP. SNAP AN E-CLIP ON ONE END OF EACH STUB AXLE AND PUSH THEM INTO THE STEERING BLOCKS FROM THE INSIDE.

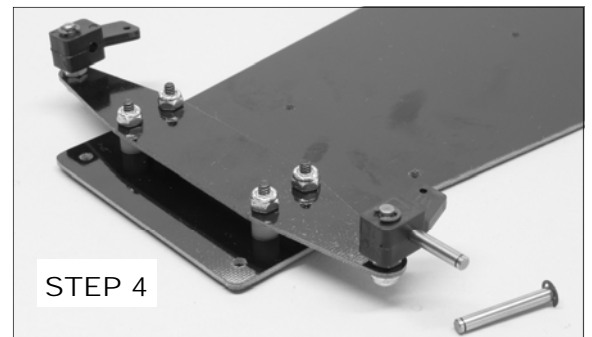

STEP 5 OPEN BAG 3 . PRESS AN OILITE BUSHING INTO THE OUTSIDE OF THE MOTOR MOUNT. ATTACH THE MOUNT TO THE CHASSIS WITH TWO ANGLE BRACKETS.NOTE THAT THE FRONT SCREW IS A FLAT HEAD AND GOES IN FROM THE INSIDE. INSTALL ALL FOUR SCREWS , THEN TIGHTEN.

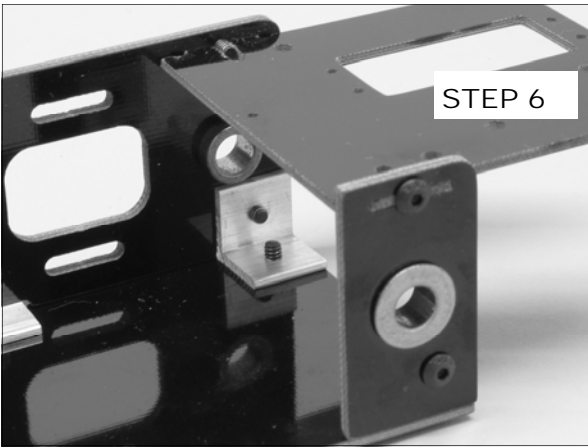

STEP 6 PRESS THE OTHER BUSHING INTO THE AXLE MOUNT. SLIDE ONE TAB ON THE SWITCH PLATE INTO THE SLOT IN THE MOTOR MOUNT, AND THE AXLE MOUNT ONTO THE OTHER TAB, AND ATTACH THE AXLE MOUNT TO THE CHASSIS WITH AN ANGLE BRACKET AND TWO 1/4" SCREWS. INSTALL 1/4" SCREWS INTO THE SLOT IN THE MOTOR AND AXLE MOUNT TO HOLD THEM TO THE SWITCH PLATE.

STEP 7 OPEN BAG 5 . ATTACH THE TWO SHORTER POSTS TO THE FRONT OF THE CHASSIS WITH TWO 3/8 SCREWS. ATTACH THE LONGER ONES AT THE REAR OF THE CHASSIS JUST IN FRONT OF THE REAR END. ADD POST NUTS ON EACH ONE.

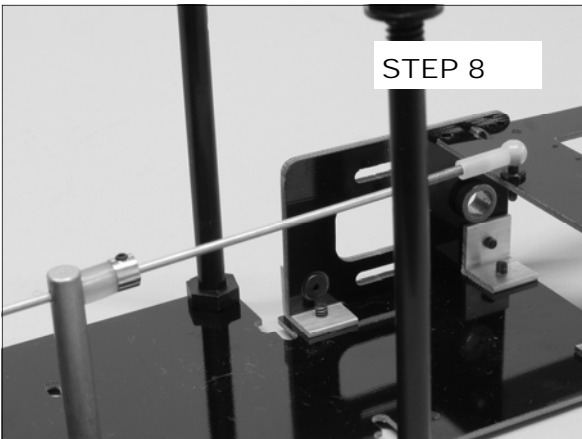
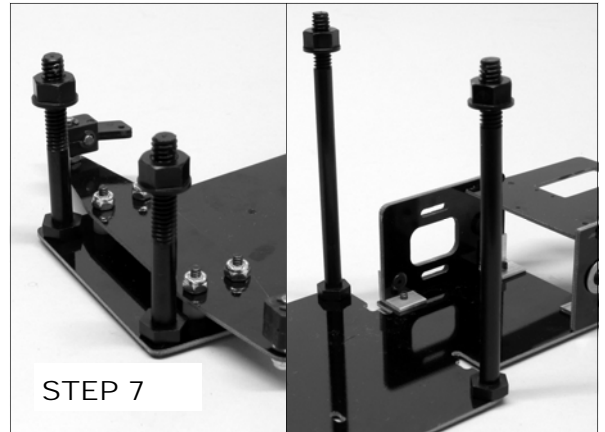

STEP 8 OPEN BAG 6 ATTACH THE SUPPORT POST TO THE CENTER OF THE CHASSIS WITH A 3/8 SCREW. THREAD THE BALL STUD INTO THE FRONT OF THE SWITCH PLATE. THREAD THE BALL CUP ONTO THE PULL ROD FROM BAG 1. SLIDE THE SET COLLAR AND SILICONE TUBE ONTO THE ROD , THEN INSERT THE ROD THRU THE HOLE NEAR THE TOP OF THE SUPPORT POST, THEN SNAP THE BALL CUP ONTO THE BALL STUD. INSTALL THE SET SCREW IN THE COLLAR, PUSH THE COLLAR AND SILICONE TUBE AGAINST THE POST AND TIGHTEN THE SET SCREW LIGHTLY. ADJUSTING THE AMOUNT OF PRESSURE ON THE POST ADJUSTS THE AMOUNT OF CHASSIS FLEX.

STEP 9 OPEN BAG 4. ATTACH THE GEAR TO THE HUB WITH TWO 3/8 BUTTON HEAD SCREWS. DO NOT OVERTIGHTEN.

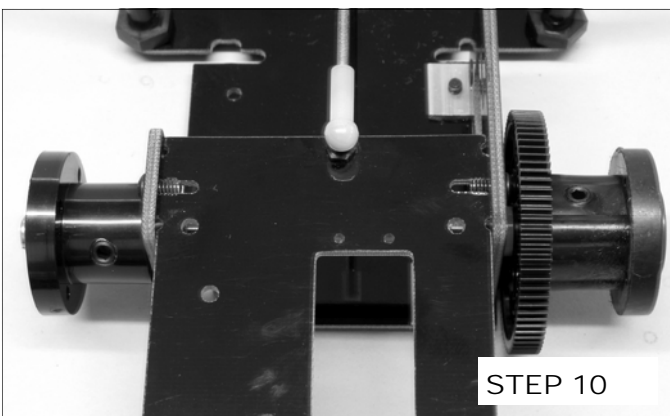

STEP 10 SLIDE THE HUB/GEAR ONTO THE AXLE AND RETAIN WITH TWO 10-32 SET SCREWS. TIGHTEN EACH CAREFULLY. PLASTIC CAN BE STRIPPED IF OVERTIGHTENED. INSTALL A NYLON AXLE SPACER ON THE AXLE, SLIDE THE AXLE THRU THE BUSHINGS, ADD TWO SPACERS AND ADD THE LEFT HUB. INSTALL TWO SET-SCREWS AND TIGHTEN CAREFULLY, ONE THEN THE OTHER UNTIL THEY ARE FAIRLY TIGHT. TIGHTENING ONE TOO MUCH AT A TIME WILL CAUSE THE TIRE AND HUB TO RUN OUT OF ROUND.

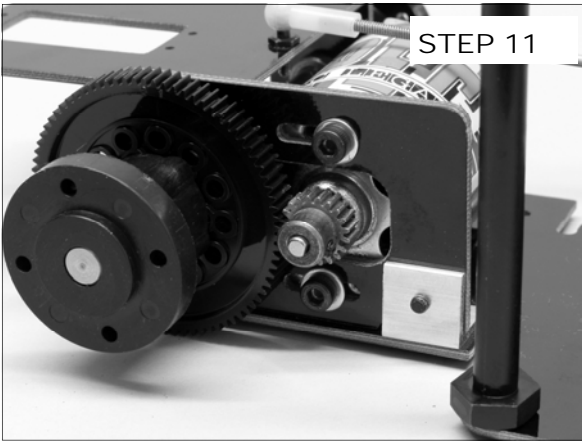

STEP 11

STEP 11 OPEN BAG 9 INSTALL THE PINION GEAR ONTO THE MOTOR YOU HAVE CHOSEN. INSTALL THE MOTOR WITH TWO M3 SCREWS AND WASHERS. MAKE SURE THE PINION IS LINED UP WITH THE AXLE GEAR, ADJUST THE MOTOR SO THERE IS A SMALL AMOUNT OF PLAY IN THE GEARS , AND TIGHTEN THE SCREWS. TURN THE AXLE A COUPLE OF TIMES TO RECHECK.

STEP 12 OPEN BAG 7 PRESS A BUSHING INTO EACH SIDE OF EACH FRONT WHEEL AND STRETCH AN O-RING ON EACH ONE. PUT A SMALL DROP OF LIGHT OIL ON EACH FRONT AXLE , INSTALL THE WHEELS AND RETAIN WITH E-CLIPS.

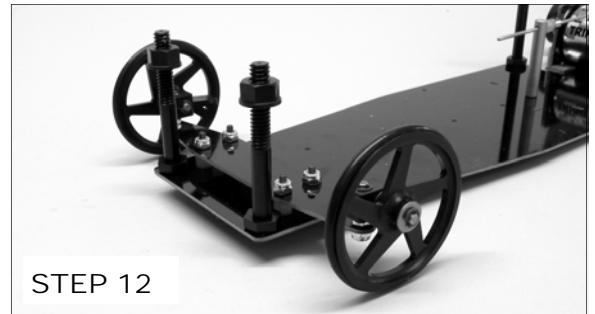

STEP 12

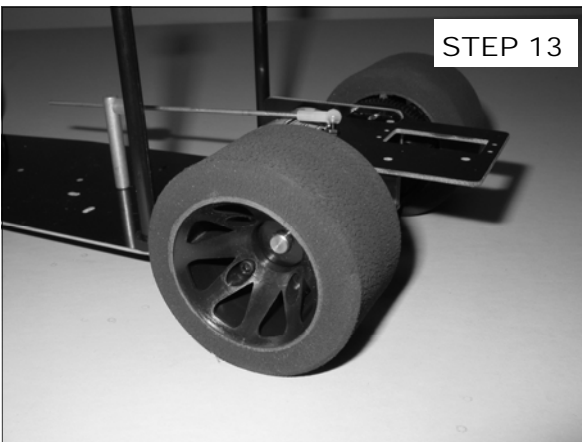

STEP 13

STEP 13 INSTALL THE REAR TIRES FROM BAG 8 WITH TWO 3/8 CAP SCREWS EACH FROM BAG 4.

STEP 14 ATTACH YOUR STEERING SERVO TO THE CHASSIS WITH SERVO TAPE, POSTS, OR SCREWS IF YOUR SERVO HAS SIDE MOUNTS. INSTALL PREBENT LINKS AND ATTACH WITH 1/8 COLLARS AND SETSCREWS. CUT THE LENGTH OF THE LINKS AS NECESSARY.

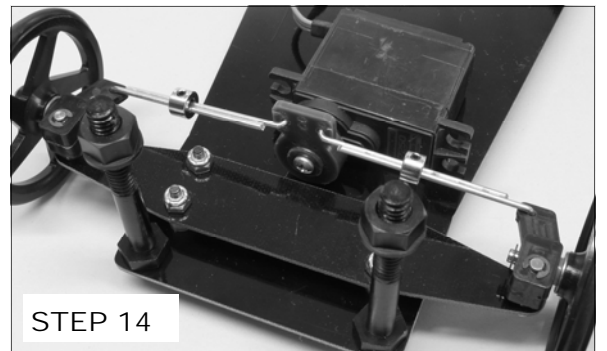

STEP 14

STEP 15 THIS STEP SHOWS HOW TO MOUNT A SMALL SERVO AND MICRO SWITCH ON THE SWITCH PLATE. YOU MAY NEED A SERVO WIRE EXTENSION IF YOURS WON'T REACH THE AREA IN FRONT OF THE RIDE HEIGHT POST WHERE YOU SHOULD MOUNT THE RECEIVER. IF YOU CHOOSE TO USE AN ESC , YOU CAN MOUNT IT ON THE SWITCH PLATE OR ON THE CHASSIS NEAR THE RCVR. THE SWITCH SHOWN IS A MICRO SWITCH BRAND 25 AMP, AVAILABLE AT MOST ELECTRONIC STORES.

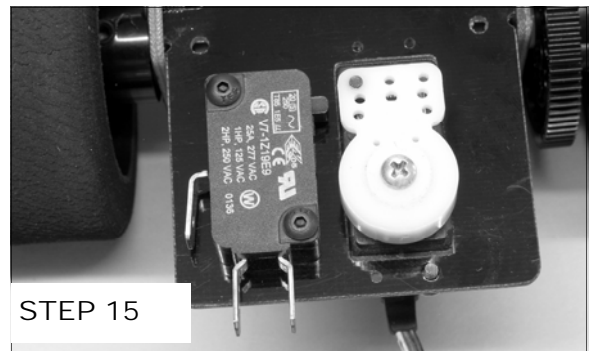

STEP 15

STEP 16 INSTALL YOUR BATTERY PACK AT THE REAR OF THE CHASSIS WITH TIE STRAPS INCLUDED. INSTRUCTIONS FOR WIRING A CAR WITH A MICRO SWITCH ARE INCLUDED. OTHERWISE WIRE YOUR RADIO AND ESC ACCORDING TO THE MANUFACTURER'S INSTRUCTIONS.

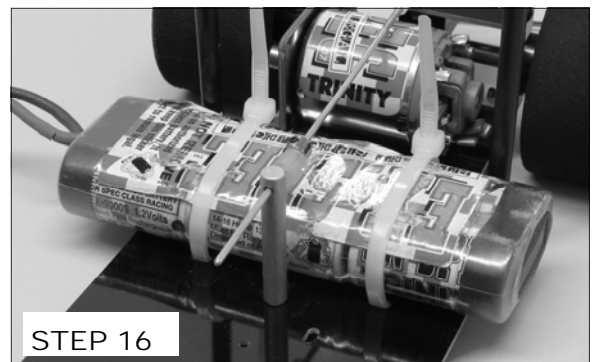

STEP 16

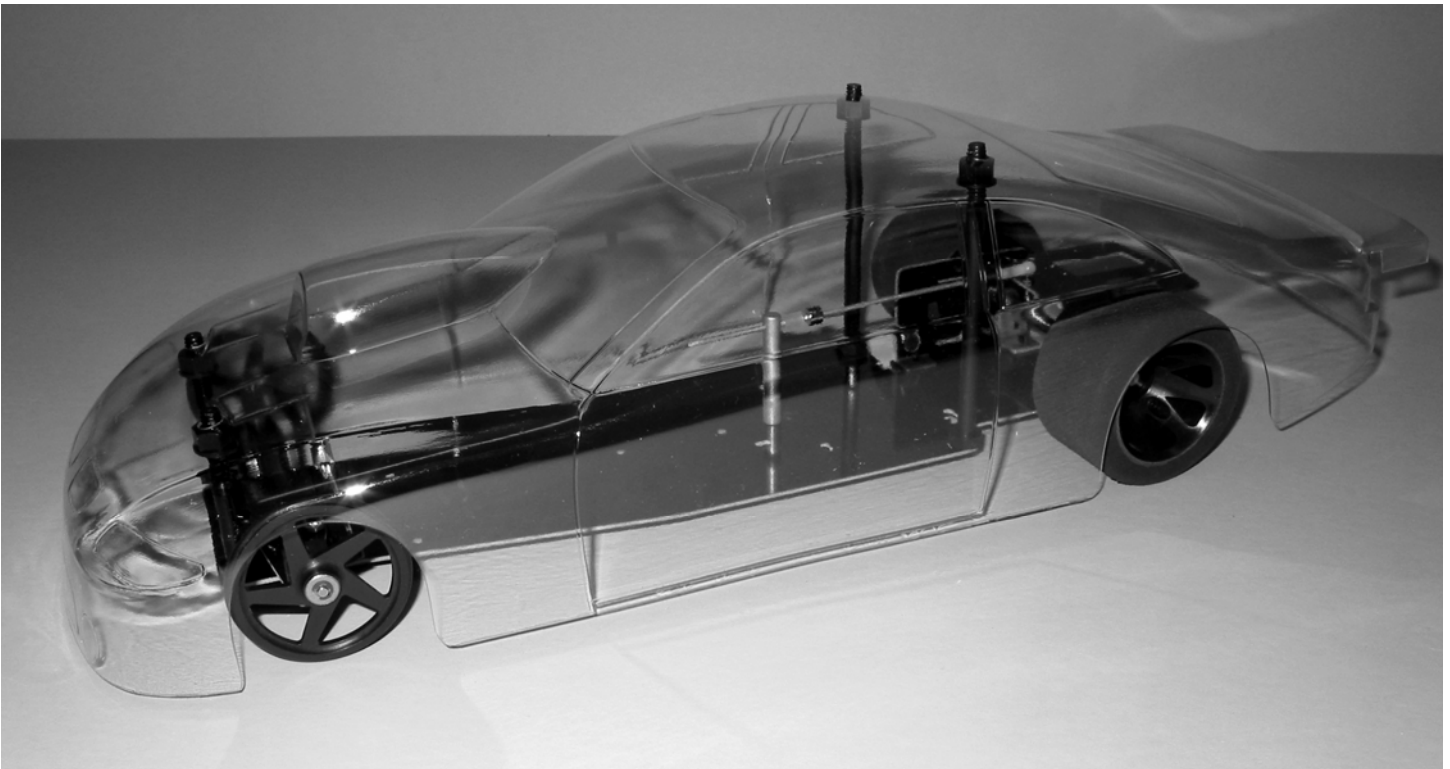

STEP 17 TRIM OUT YOUR BODY, SET OVER THE CHASSIS AND MARK THE OUTSIDE FOR POST HOLES AND WHEEL CUTOUTS, PAINT THE BODY AND WING, CUT OUT AND DRILL MOUNT HOLES, MOUNT THE WING TO THE TRUNK WITH SERVO TAPE OR SMALL SCREWS ,THEN PEEL THE PROTECTIVE FILM. CHARGE YOUR BATTERY, CHECK OUT YOUR RADIO SETTINGS AND ADJUSTMENTS AND THEN GO OUT AND HAVE SOME FUN! REPLACEMENT PARTS AND ACCESSORIES ARE AVAILABLE THRU YOUR LOCAL HOBBY SHOP.

SEE www.rjspeed.com FOR A LISTING OF NEW PRODUCTS AND ACCESSORIES

WIRING FOR MICRO SWITCH SPEED CONTROL

